

Super-Flex® Traveling Cable Simplified Installation Instructions



IMPORTANT: READ THIS FIRST

This is only a brief summary of installation procedures; for more details, refer to the Draka EHC Super-Flex Traveling Cable Installation Guide. Only full compliance with that Guide's procedures will ensure full product warranty coverage.

Step 1 - Storage and Handling: Immediately inspect cables when they arrive at the job site to ensure they have not been damaged in route. Store traveling cables in a secure area to avoid damage resulting from other construction activities.

Step 2 - Cable End Preparation: Take extreme care to avoid damaging the insulation of the wires when removing the jacket and braid. If available, use a Flexi-Peeler (part # 36-060) to remove the jacket. Remove the braid with the Sock Slicer (part # 36-177). Other braid removal methods include using blunt-tipped medical scissors or making short, light strokes with a utility knife.

Step 3 - Raising Cable in Hoistway: When pulling cable up a hoistway or lowering it by use of the car, the cable should pay off from the bottom of the reel or coil to minimize twisting and bending. A properly-sized split wire mesh grip can be used to raise the cable.

When feeding cable down the hoistway, it should pay off from the top of the reel or coil.

Step 4 - Pre-Hanging the Cable / Recommended Method: Pre-hanging the cable relieves internal stress that may have developed during re-reeling and handling. This procedure secures the steel support and outer cable core as a unit while permitting the lower cable end to hang freely.

It is recommended that the cable should remain in the pre-hanging position for at least 24 hours.

It is recommended that the cable be temporarily secured to prevent the upper cable end from rotating during pre-hanging.

The lower end of the cable should clear the pit floor by at least 1 foot • 30 cm to allow space for any straightening of the cable. The cable should be pulled away and prevented from resting against the wall or any other part of the hoistway.

Step 4a - Pre-Hanging the Cable / Alternate Method: This alternate method for pre-hanging is explained in the Super-Flex Installation Guide. Although this method provides some degree of torsional relief, IT DOES NOT ASSURE COMPLETE TORSIONAL STRESS RELIEF because the lower cable end is not free to rotate. The line used to pull the cable away from the wall should form a loose noose that holds, but does not grip, the cable.

Step 2 - Use a Flexi-Peeler to cut the jacket and a Sock-Slicer to cut the braid. DO NOT nick the conductor insulation

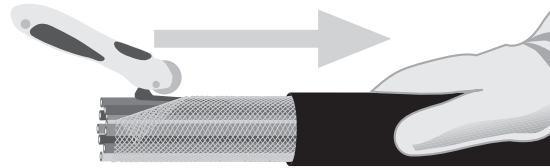

Step 3 - When pulling cable up, cable pays off the bottom of the reel. When feeding cable down, cable pays off the top of the coil.

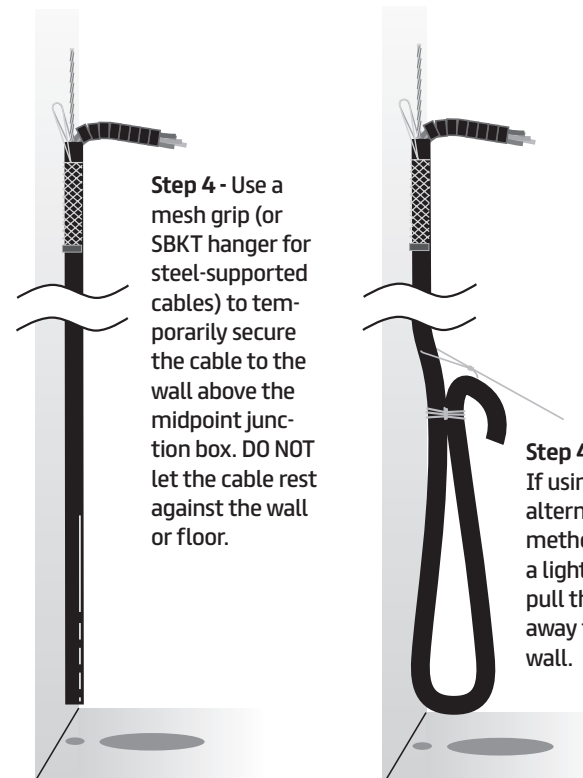
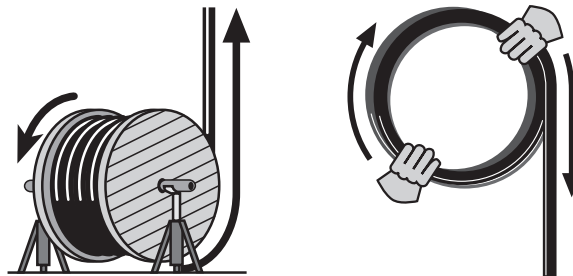

Step 4 - Use a mesh grip (or SBKT hanger for steel-supported cables) to temporarily secure the cable to the wall above the midpoint junction box. DO NOT let the cable rest against the wall or floor.

Step 4a - If using the alternate method, use a light line to pull the cable away from the wall.

Draka EHC

A Brand of Prysmian Group

Draka EHC
2151 N. Church Street | Rocky Mount, NC 27804
+1-877-DRAKA EP (877-372-5237)
www.DrakaEHC.com | www.prysmiangroup.com

Super-Flex® Traveling Cable Simplified Installation Instructions (cont'd)



Step 5 - Attachment to Hangers: The steel support member must be permanently attached prior to connecting any electrical conductors. Sufficient slack should be provided in the conductors to prevent the weight of the cable from being applied to them. While several methods exist to support traveling cables, the Draka EHC Universal Hanger is recommended for steel supported cables.

UNIVERSAL HANGING SYSTEM - US PATENT 5,080,199

Part Number	For Steel Core Dia. in • mm	Number of Cables Held	Max. per Cable Load lbs • kg
3/32-1 SBKT	3/32 • 2.4	1 cable	500 • 227
1/8-1 SBKT	1/8 • 3.2	1 cable	500 • 227
5/32-1 SBKT-R	5/32 • 4.0	1 cable	700 • 318
1/4-1 SBKT	1/4 • 6.4	1 cable	1250 • 568
5/32-2 SBKT-R	5/32 • 4.0	2 cables	700 • 318
1/4-2 SBKT	1/4 • 6.4	2 cables	1250 • 568

Strip 8 inches • 20 cm of insulation from the steel support member (15 inches • 40 cm if using cable stop hardware). Insert the bare steel into the bottom end of the hanger strand vise until the steel protrudes from the top end. Pull down on the cable to lock it into position.

Immediately after the steel support member is terminated, tighten the metal straps to secure the traveling cable. This will allow the cable to act as a single unit; the rotation position of the cable is set and secured by tightening these straps

Form the cable stop by passing the flat washer over the steel so that it rests on the strand vise. Form a loop with the steel around the thimble and fasten the clip. There should be at least 1/2 inch • 13 mm clearance between the washer and the clip.

Wire mesh grips are recommended for supporting the cable lengths of 200 feet • 61 m or less (as specified in the National Electrical Code); electrical tape must be wrapped around the base of the mesh grip to prevent it from slipping

NOTE: The manufacturer's identification markings on the cable's jacket SHOULD NOT be used to determine the alignment of the cable.

Step 6 - Final Installation Steps: For optimum performance, sides of the cable loop should remain parallel during the elevator operation. Loop curvature should be smooth and free of kinks and pivot points. Loop diameters are determined by the formula Cable OD x 30. The loop diameter should be ±10% of this calculation. (Example: a cable of 1 in. diameter x 30 = a loop of 27 to 33 inches [30 inches ±10%])

Finally, a routine inspection program should be implemented to maximize product performance and safety.

NOTE: All installation hardware can be obtained from Draka EHC. Consult our catalog or call us for sizing information.

Draka EHC reserves the right to improve, enhance and modify the features and specifications of our products without prior notification.

Step 5 - Universal Hanger

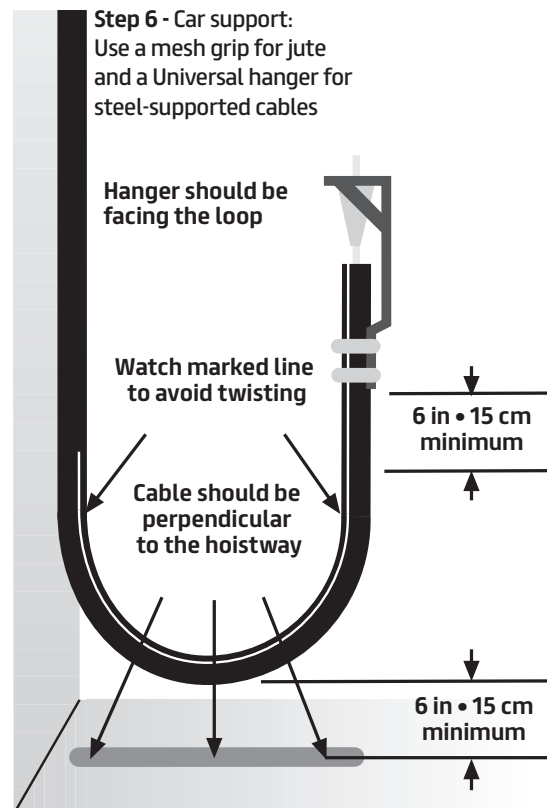
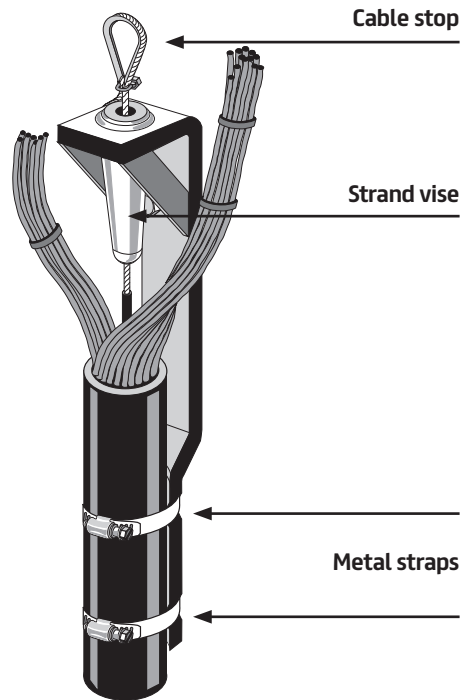

Draka EHC

A Brand of Prysmian Group

Draka EHC
2151 N. Church Street | Rocky Mount, NC 27804
+1-877-DRAKA EP (877-372-5237)
www.DrakaEHC.com | www.prysmiangroup.com