

Draka EHC Elevator Rope Brake (ERB)

ERB10 / ERB20 / ERB35



PROTECTION AGAINST OVERSPEED AND UNINTENDED CAR MOVEMENT

Introducing the Draka EHC series of Elevator Rope Brakes (ERBs). Draka EHC's new Elevator Rope Brake (ERB) series delivers enhanced safety for passengers and technicians by protecting against ascending car overspeed, unintended car movement, and exceeding rated buffer striking speed.

Consisting of three models (ERB10 / ERB20 / ERB35) to accommodate a wide range of operating parameters, configurations, rope diameters and spreads, the ERB's electromechanical design offers numerous value-added benefits over hydraulic rope brakes.

FEATURES & BENEFITS

- Electromechanical design
- No hydraulic pump or fluid required
- Compact design and small footprint
- Quick and simple installation
- Pads do not require grooving
- Easy to maintain
- LED operating and warning indicators
- Remote customer support
- Lower cost of ownership

The ERB10 and ERB20 can accommodate rope diameters from 3/8 to 5/8 inches (9.5 to 16 mm) while the ERB35 can accommodate rope diameters from 7/16 to 3/4 inches (11 to 19 mm).

TESTED AND CERTIFIED

ISO 9001 Certificate

Certified by Liftinstituut to meet ASME A17.1 2019, CSA B44.1/ ASME A17.5, EN 81-20:2020 and EN-81-50:2020 standards



Part Number	Description
ELH-RB-ERB10	ERB10 kit for 3/8 to 5/8 in • 9.5 to 16 mm ropes
ELH-DRAKA-ERB10	Above, with cable and manual
ELH-DRAKA-ERB10-0	ERB10 brake kit with larger/optional pad installed
ELH-RB-ERB20	ERB20 kit for 3/8 to 5/8 in • 9.5 to 16 mm ropes
ELH-DRAKA-ERB20	Above, with cable and manual
ELH-DRAKA-ERB20-0	ERB20 brake kit with larger/optional pad installed
ELH-RB-ERB35	ERB35 brake for 7/16 to 11/16 in • 11 to 16 mm ropes
ELH-DRAKA-ERB35	Above, with cable and manual
ELH-DRAKA-ERB35-0	ERB35 brake kit with larger/optional pad installed
ELH-ERB35-EXTKIT	Extension kit for 19 mm and 3/4 inch versions
ELH-RB-ERB-CABLE	Power cable for all ERB units
ELH-RB-ERB-MANUAL	Installation manual for all ERB units

- 1 Stationary brake lining
- 2 Brake clamp spring on guide rods
- 3 Brake clamp lining
- 4 Brake clamp
- 5 Attachment bolts
- 6 Top and back covers
- 7 Power switch
- 8 Safety bolt
- 9 Clamp arm
- 10 Shim (spacer)
- 11 Adjustable mounting bracket

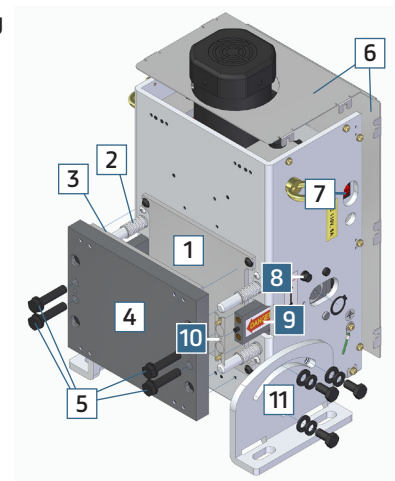

Draka EHC

A Brand of Prysmian Group

Draka EHC
2151 N. Church Street | Rocky Mount, NC 27804 | 1-877-DRAKA EP (877-372-5237)
+1-252-984-5100 | Fax +1-252-972-6001 | Tech support + 1-877-408-4357
www.DrakaEHC.com | www.prysmiangroup.com

ELEVATOR ROPE BRAKE (ERB) OPERATING PARAMETERS

Criteria	Unit	ERB10	ERB20	ERB35
Power Supply		110VAC 6A	110VAC 6A	110VAC 6A
Contact Ratings		120VAC, 1Ø, 2A	120VAC, 1Ø, 2A	120VAC, 1Ø, 2A
Spread of Main Ropes* standard (optional)	in mm	4.92 (5.98) 125 (152)	4.92 (5.98) 125 (152)	6.30 (7.56) 160 (192)
1 : 1 ROPING				
Rated Speed (min - max)	ft/sec m/sec	1.3 - 10.1 0.4 - 3.1	1.3 - 13.1 0.4 - 4.0	1.3 - 10.1 0.4 - 3.1
Car Rated Load (min - max)	lbs kg	772 - 2205 350 - 1000	1322 - 3527 600 - 1600	2205 - 5511 1000 - 2500
System Mass (min - max) (Car, CWT & Rope)	lbs kg	2094 - 9480 950 - 4300	3306 - 14880 1500 - 6750	4630 - 18740 2100 - 8500
Total Mass (min - max) (Car, Load, CWT & Rope)	lbs kg	2866 - 11684 1300 - 5300	4630 - 18408 2100 - 8350	6834 - 23149 3100 - 10500
2 : 1 ROPING				
Rated Speed (min - max)	ft/sec m/sec	0.66 - 5.2 0.2 - 1.6	0.66 - 6.6 0.2 - 2.0	0.66 - 5.2 0.2 - 1.6
Car Rated Load (min - max)	lbs kg	1543 - 4409 700 - 2000	2644 - 7054 1200 - 3200	4410 - 11022 2000 - 5000
System Mass (min - max) (Car, CWT & Rope)	lbs kg	4189 - 18960 1900 - 8600	6612 - 29760 3000 - 13500	9260 - 37490 4200 - 17000
Total Mass (min - max) (Car, Load, CWT & Rope)	lbs kg	5732 - 23369 2600 - 10600	9260 - 36816 4200 - 16700	13669 - 46297 6200 - 21000
DIMENSIONS				
Net Weight	lbs kg	82 37	82 37	117 53
Gross Weight	lbs kg	86 39	86 39	124 56
Packing Size (W x L x H)	in mm	13.4 x 18.9 x 9.8 340 x 480 x 250	13.4 x 18.9 x 9.8 340 x 480 x 250	13.8 x 20.9 x 10.2 350 x 530 x 260

*How to calculate whether you need the standard or optional (wider) spread version:

$\phi + P \times (n-1) < \text{maximum width of the rope spread}$ where ϕ (rope diameter), P (Pitch), n (number of ropes)

Example of calculating formulas (ERB20 @ width 125mm)

Ex: $\phi 12 + 19\text{mm} \times (6 - 1) = 107 \text{ mm}$ (which is less than the standard spread of 125 mm - standard spread is OK)

Ex: $\phi 12 + 19\text{mm} \times (7 - 1) = 126 \text{ mm}$ (which is greater than the standard spread of 125 mm, so order the optional 152 mm spread)

Draka EHC

A Brand of Prysmian Group

Draka EHC

2151 N. Church Street | Rocky Mount, NC 27804 | 1-877-DRAKA EP (877-372-5237)
+1-252-984-5100 | Fax +1-252-972-6001 | Tech support + 1-877-408-4357
www.DrakaEHC.com | www.prysmiangroup.com